

CITY OF BONITA SPRINGS
WEDNESDAY, OCTOBER 5, 2016
4:00 P.M.
CITY HALL
9101 BONITA BEACH ROAD
BONITA SPRINGS, FLORIDA 34135
WORKSHOP
MINUTES

I. CALL TO ORDER

Mayor Peter Simmons called the workshop to order at 4:00 P.M.

II. PLEDGE OF ALLEGIANCE

At the request of Mayor Simmons, Council Member Steve Slachta led in the Pledge of Allegiance.

III. ROLL CALL

Mayor Simmons and all Council Members were in attendance.

IV. PUBLIC COMMENT

Rick Steinmeyer questioned the hours of operation for the skate park.

V. PRESENTATION ON POTENTIAL LOCATIONS FOR A SKATE PARK IN THE CITY.

4:03:49 PM Nicole Perino, Director of Parks and Recreation, furnished a PowerPoint presentation (attached hereto) to address potential locations for a skate park to be located in the City of Bonita Springs. She also addressed other skate parks and their features for the various municipalities in the area and those located within Lee and Collier County.

4:40:49 pm Mayor Simmons stated that City Council consensus was to move forward with a skate park. The Kentucky Street site was eliminated. Council consensus on the two Council choices for a park was the current location and Depot Park. Council discussion followed.

4:55:50 pm City Manager Carl Schwing clarified that Staff to further investigate, gather information and bring back to City Council.

VI. PUBLIC COMMENT

4:59:35 pm Rick Steinmeyer suggested tearing everything down and look at the site and then figure it out. He feels this is the right direction.

VII. ADJOURNMENT

There being no further items to discuss the meeting adjourned at 5:00 P.M.

Respectfully submitted,

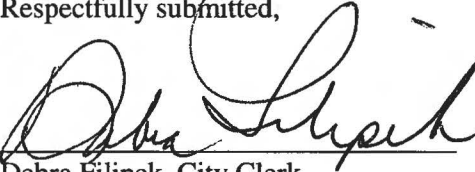

Debra Filipek, City Clerk

APPROVED:
BONITA SPRINGS CITY COUNCIL:

Date: 10/20/16

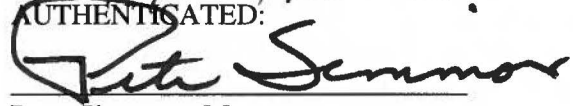
AUTHENTICATED:

Peter Simmons, Mayor

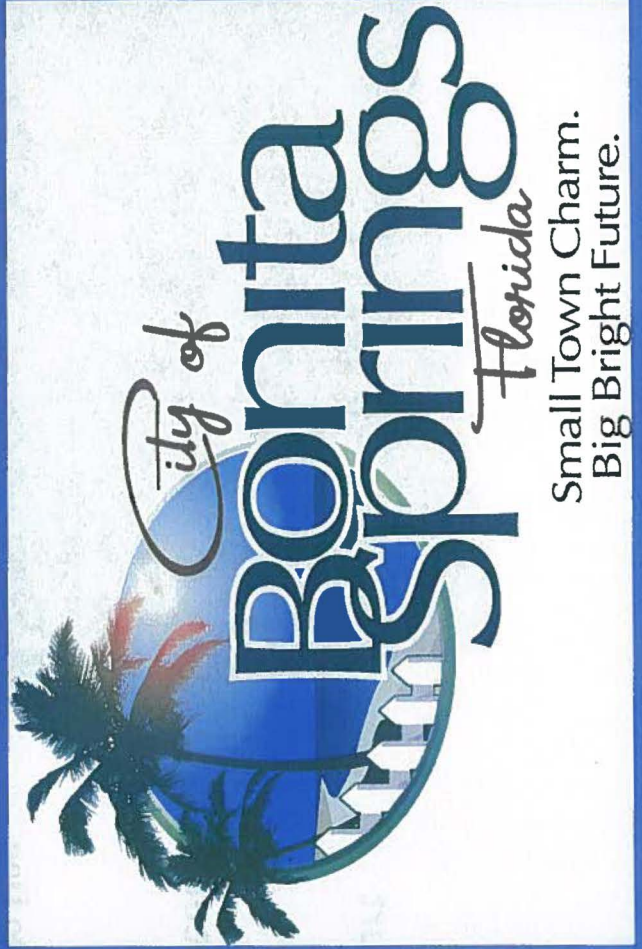
Skate Park Location Options



**Dean St. Vacant
property
0.35 Acres
15,000 Square feet**

Pros:

- **Adjacent to Bonita Springs Elementary**
- **Parking**
- **Close to Downtown**
- **Mid-sized parcel for possible expansion**

Cons:

- **No restrooms**
- **Not visible from Old 41**
- **Site prep work costly due to tree removal**



Depot Park

0.54 acres
23,700 Square Feet

Pros:

- Restroom facilities
- Downtown location
- Visible from Riverside Park, Old 41 & Pennsylvania Ave
- Parking
- Drinking fountains
- Shaded Picnic areas
- Large parcel for easy expansion

Cons:

- Area used for some events
- Would the skate park fit into the natural surroundings of the Park



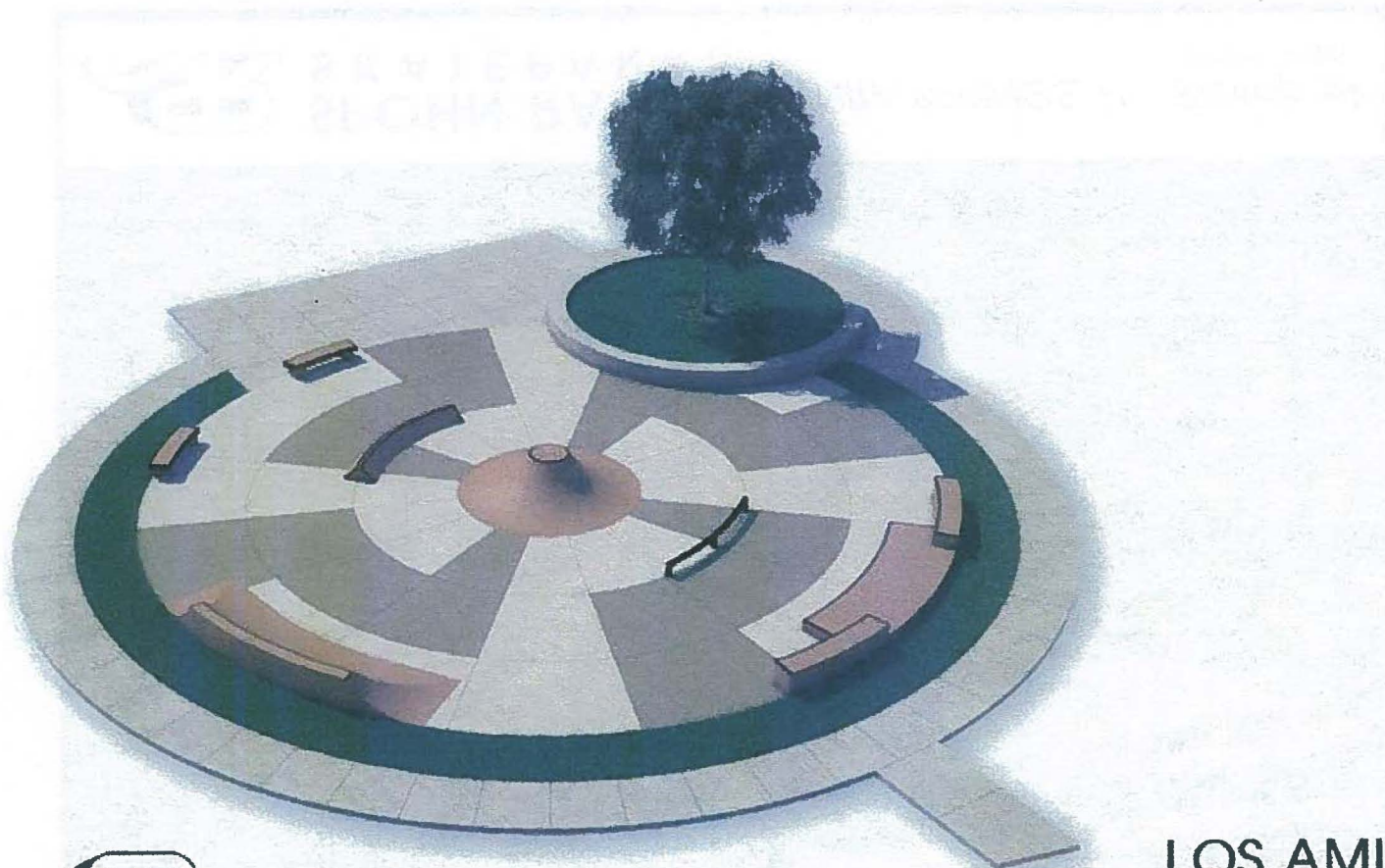

**LOS AMIGOS
SKATE SPOT**
CITY OF RANCHO CUCAMONGA

Option 1: 3,000 Square ft. Concrete Park approximate cost \$130,000



SPOHN RANCH
SKATEPARKS

BONITA SPRINGS, FL - Skatepark
Sample Design 3

Option 3: 6,500 Square ft. Concrete Park approximate cost \$265,000



SPOHN RANCH
SKATEPARKS

BONITA SPRINGS, FL - Skatepark
Sample Design 4

Option 5: 20,000 Square ft. Concrete Park approximate cost \$800,000 - \$900,000



Local Skate Park Information

The Edge Skate Park at Fleischmann Park – Naples

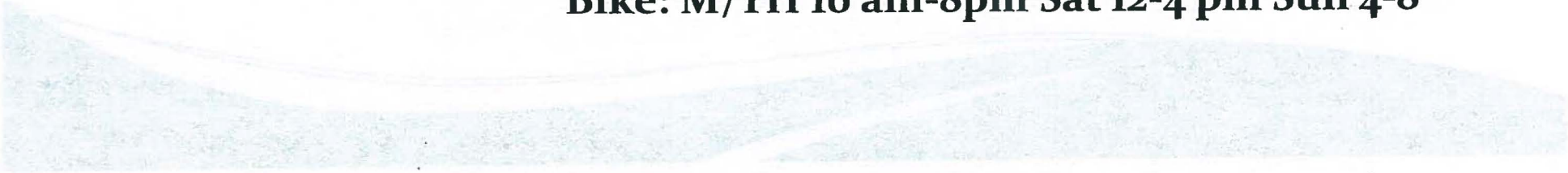
- **40,000 Sq. ft. Skate park with a combination of both wood and concrete features**
 - **Not supervised, use at your own risk**
 - **Fees: Collier Co. Residents Annual pass: \$60**
 - **Non-Resident 6 month pass: \$60**
 - **Daily Fee: \$20**
 - **130 members**
 - **Approximately 10 -30 participants per day, weather depending**
 - **Hours of operation: Skate: TWF 10 am -8 pm Sat. 4-8 pm Sun 12 -4**
 - **Bike: M/TH 10 am-8pm Sat 12-4 pm Sun 4-8**
- 



Local Skate Park Info (con't)

Wheels Skate Park and BMX Track – Naples

- **25,000 Sq. ft. for Skate Park section only**
 - **Not Supervised, but staff can view cameras from Rec Center**
 - **Fee: Under 18 annual pass: \$10**
 - **Over 18 annual pass: \$25**
 - **Daily Fee: \$5**
 - **300 members, but includes the BMX track as well**
 - **Approximately 30 participants per day for skate park only**
 - **Hours of Operation: M/T/W/F 3 – 8 pm**
 - **Saturday 1 -8:30 pm**
 - **Sunday 1 – 6 pm**
 - **Thursday closed**
- 



Timeline for Construction

- **The procurement process for a Design Build project is approximately 4-5 months for a contractor to be selected**
- **The timeline for construction will depend on location chosen and the amount of site prep work required. Construction with minimal site prep will be approximately 3-4 months**